

Innovation

Our design engineers carefully analyze each drilling application and develop practical and comprehensive solutions for even the most complex challenges.

Quality

Meticulous craftsmanship is one of our hallmarks. No product leaves our factory without passing some of the strictest quality control standards in the industry.



Service

Our marketing teams and field engineers, with local knowledge and experience, offer one-on-one support to customers around the world.



BesteBit offers a full line of fixed cutter bits and premium downhole drilling tools.

Matrix and Steel
Body PDC Bits

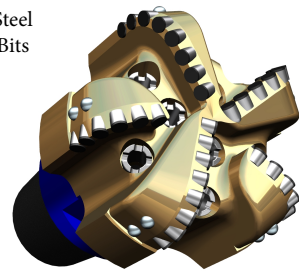

Bi-Center
Bits

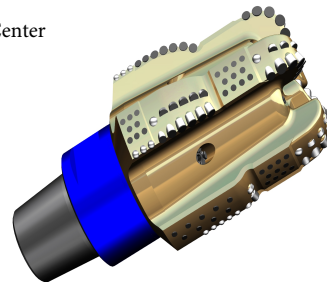

Natural Diamond
Bits

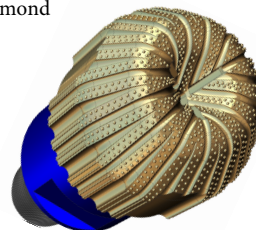

Shuriken®
Reamer

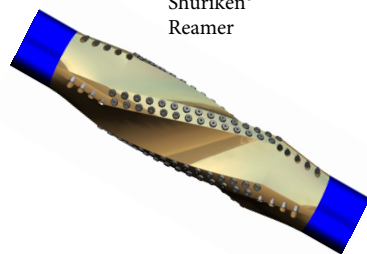

Stiletto™ Under
Reamer

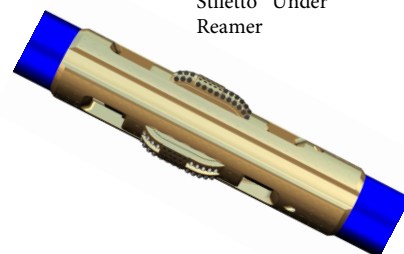

SpinDrift™ Roller
Reamer

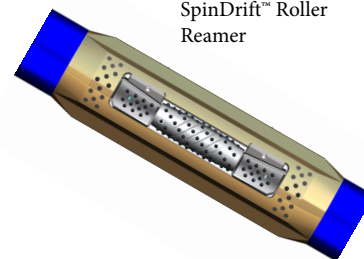

For more information on our drill bits and drilling tools visit us at - www.bestebit.com

BESTEBIT

Step Drill-FHO Reamer

Simple and reliable hole enlargement

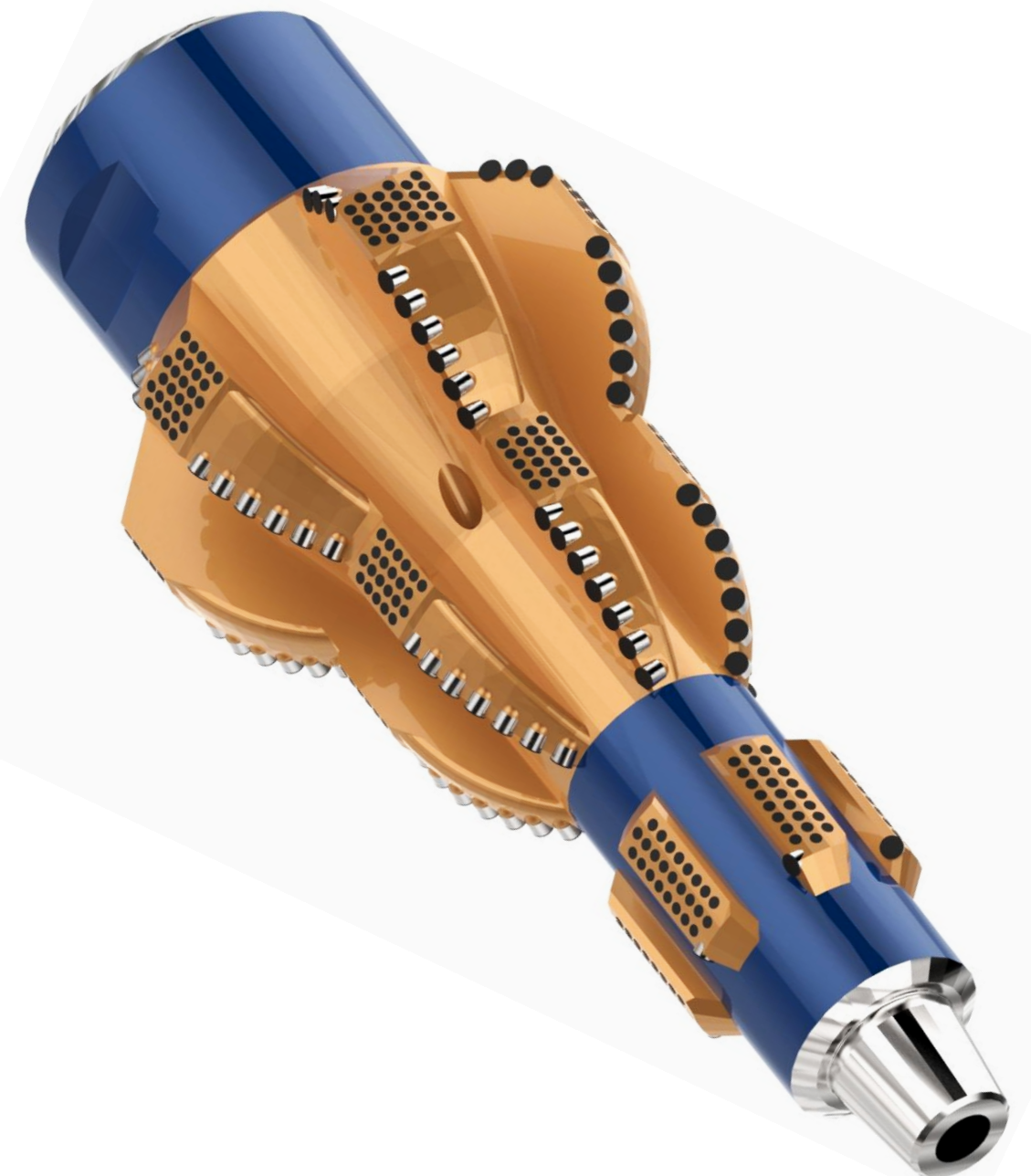

Chengdu Best Diamond Bit Co., Ltd.
No.789, Keyuan South 2nd Road, Hi-Tech District
Chengdu, Sichuan, China 610041
Telephone: 86-28-85311882

©2016 BESTEBIT LLC All Rights Reserved | Ver01
0616

Step-Drill FHO (Fixed Hole Opener)

Simple and reliable hole enlargement

Step-Drill FHO is a multi-staged fixed diameter concentric PDC hole opener designed for fast, smooth and durable concentric hole opening in a wide variety of hole diameters, formations and application conditions. Each stage of this design works in conjunction with the other stages to provide smooth reliable performance on either rotary or rotary steerable assemblies, for both vertical and directional applications.

The robust design of the Step-Drill FHO is ideally suited for both large borehole diameters and large diameter opening ratios. Openings of 8-1/2" to 17-1/2" and 12-1/4" to 26" are readily achievable in even the most challenging formations.



5

The fifth and final stage of the tool consists of shorter gauge pads for directional capabilities and backream cutters to ensure smooth tripping out of the hole.

4

The next stage provides minimal cutting and relieves the formation for the more aggressive cutting fourth stage. Both of these cutting sections of the tool feature premium Trident™ PDC cutters, strategically placed for balanced work loads, optimum durability and faster ROP.

3

2

The second stage integral to the tool consists of passive gauge pads which provide initial stabilization and centering of the tool.

1

The first stage can be either a pilot bit for drilling ahead or a bullnose for hole opening.

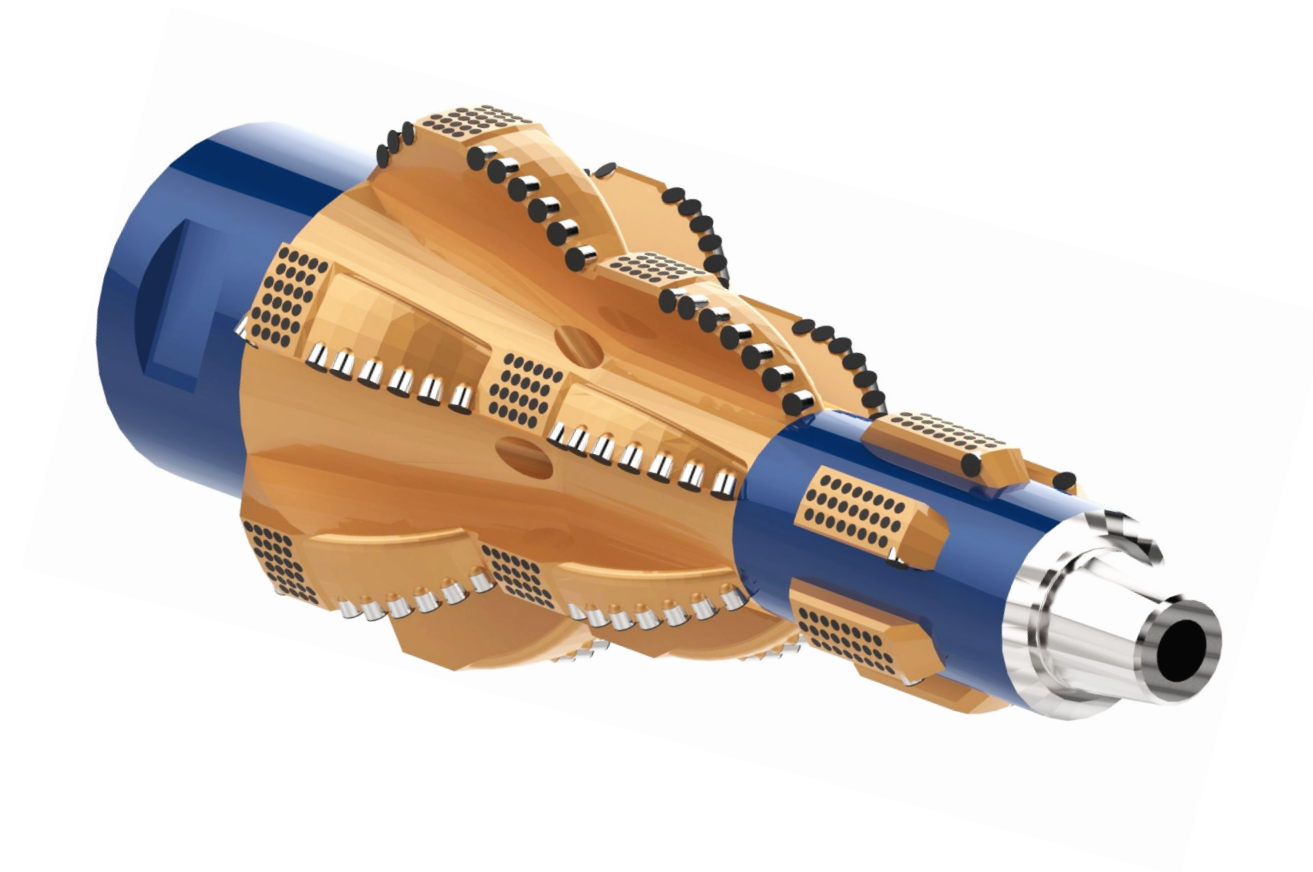

Features

- Straightforward single-body FEA-modeled tool design
- Application-specific Trident™ PDC cutters
- Increased working area for higher cutter count and density
- Optimized gauge design for directional responsiveness
- Integral stabilization, centralization and hole conditioning
- Integrated hydraulics for improved hole cleaning

Benefits

- High quality hole opening at an aggressive ROP
- Improved bit stability while drilling ahead
- Suitable for both conventional steerable motor and RSS systems
- Operational simplicity and reliability with no moving parts
- Back ream through tight spots, ledges and doglegs
- Configurable with roller cone, PDC or bull nose
- Applicable in a wide range of drillstring or BHA configurations